



SPECIFICATIONS

RATING: 30mA / 28VDC

OPERATING SPEED: 10mm/sec

ELECTRIC LIFE: 20,000 cycles

FULL TRAVELS: 2.0mm

OPERATING TEMPERATURE: -40°C to 95°C

MATERIALS

PUSHER: POM Black

DUST PROTECTION CAP: POM Black

CASE: PA Nature glass fiber reinforced

SPRING: Piano wire

CONTACT/TERMINALS: Brass, silver plated



SWITCH FUNCTION

SPST

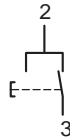

SPDT



POLE OPTIONS

SPST

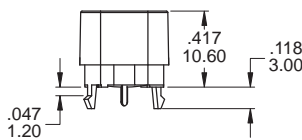
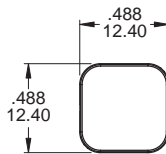

Part No. Shown : PS3001

NOTE

Force: G3.4~6.4N

Operating position: $8.9 \pm 0.2\text{mm}$

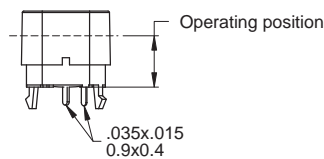

P.C. MOUNTING

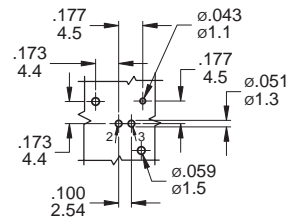

SPDT

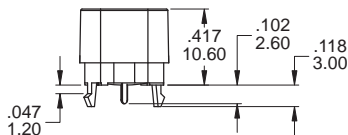
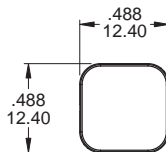

Part No. Shown : PS3002

NOTE

Force 1: G5~7N

Force 2: G11~14N

Operating position 1: $9.7 \pm 0.2\text{mm}$

Operating position 2: $8.9 \pm 0.2\text{mm}$

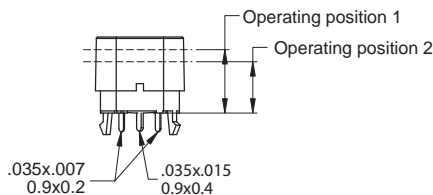

P.C. MOUNTING

